



DOOR | Since 2004



 **KANGTON INDUSTRY, INC.**



Add: 1908 T2 tower, Ruihong CA, 118 Feihong Rd, Shanghai, China
Tel: +86 21 55151611, 65081808
Fax: +86 21 55159770
Email: webmaster@kangton.com
Web: www.kangton.com

DOOR



Company Introduction

Kangton Industry, Inc. is a superior supplier of door in China. Since 2004, we've been sharing good markets worldwide. Our strengths are commercial wooden door, laminate door and wood veneer door. We provide one stop door solution to clients, including interior, exterior, and the fire rated door.

With BV ISO9001, 14001, 45001, CE, Intertek, SGS, and FSC certificates, our doors are successfully accepted by big brand, real estate, developer and wholesale company all over the world. You can find our doors in different projects in North America, Europe, Australia, Southeast Asia, South America, Middle East and Africa.

Kangton select our strategic partners with international quality standard. We strictly control the quality and provide inspection during production and before loading. All our clients will receive QC report with detailed photos of each shipment. We are responsible for powerful competitive price, top quality and developing new product. Our experienced consultant team will ensure our clients completely be leadership in the market.

One Stop DDP service is available, includes shipping, tax, duty, to door charges. Our aim is to create extra value to our clients and develop together.

Whatever you need for doors, we believe you can find the best in Kangton.

2004

Since



SHAKER SERIES



KDP01A-S

KDP02A-S

KDP03D-S

KDP05C-S

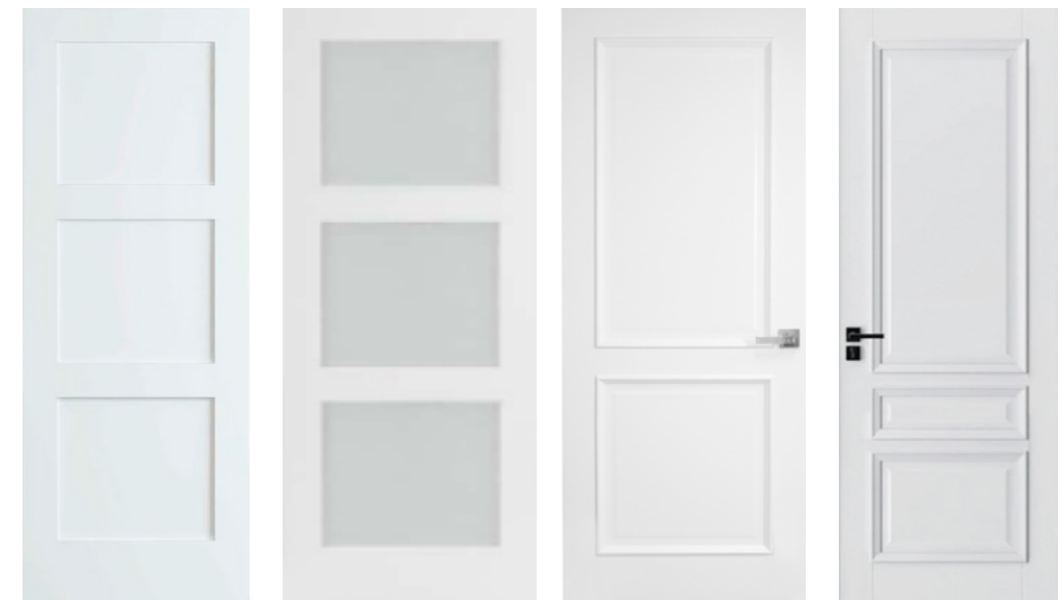

KDP03C-S

KDP03C-G

KDP02-R

KDP03-R

Height	78",80",82"84"86",96"
Width	24",26",28"30"32",34"36"
Thickness	25mm,35mm,40mm,45mm,50mm
Design	Flush,Grooved,Shaker, Raised panel, Glasses



WOOD VENEER SERIES



KDFV00-3



KDFV00-1

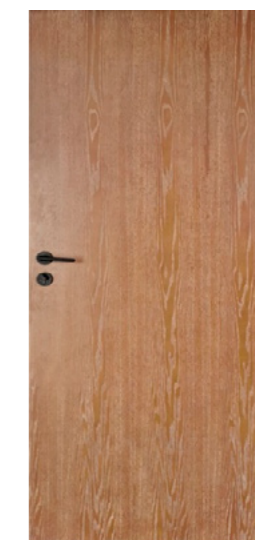

KDFV00-2



KDFV22-2



KDFV40-1



KDFV42-L



KDFV40-4

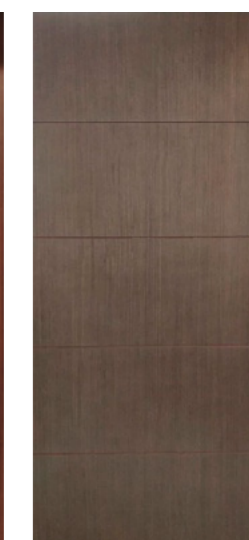

KDFV40-3

More color option



KC4001



KC4002

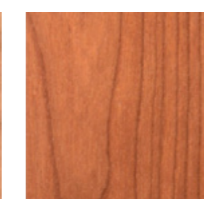

KC4003

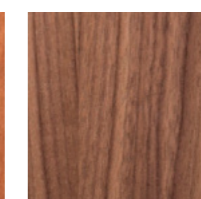

KC4004

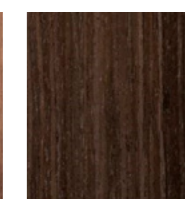

KC4005

LAMINATE SERIES

Melamine



KDM00-1

KDM40-1

KDM00-2

KDM00-3

HPL



KDH01-1

KDH00-2

KDH00-3

KDH00-4

More color option

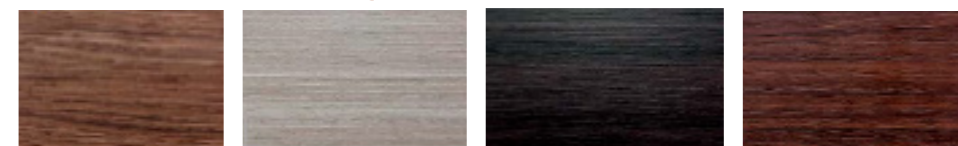

KT3366-Z

KT3605-S

KT3424-S

KT3618-Z



KT3686-Y

KT3687-Q

KT3619-Z

KT3682-Y



FIRE RATED DOOR

The top level fire rated infilling, board and glue can assure 30mins, 45mins, 60mins, 90mins and 120mins fire rated effects.
Thickness: 45mm, 50mm, 60mm, 70mm



KDF41G



KDF41G



KTSS-5003



KTSS-5004



KTSS-0001



KDF00A



KTSM-0001



KTSS-0002



Wooden Fire Proof Door Structure

- Hinges
- Fire proof handle
- Decorative adhesive strip
- High quality panel
- Solid wood edge banding
- Fire retardant wood skeleton
- Fire retardant core board



Steel fire-Proof Door Structure

- Hinges
- Fire retardant expansive plastic seal
- Super strong circular lock
- Door surface
- Infilled fire resistant core board
- High quality stainless steel doorsill
- Super thick steel plate



Fire-rated Lifting Sealing Strip



Fireproof Smoke Seal Strip



UL Tag - Black for Door, Silver for Frame

WATERPROOF DOOR

100% Termite -Free



KDW01



KDW02



KDW03



KDW04

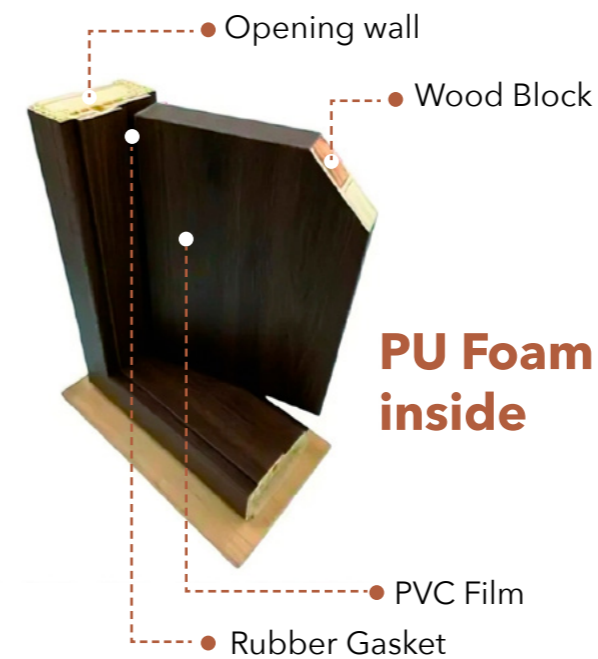

WPC stands for Wood Plastic Composite. WPC doors have a unique combination of wood fiber, bamboo powder, and thermoplastic resins. It is a relatively new green material that offers the benefits and advantages of both wood and plastic. WPC provides an innovative technology that is far better than traditional wood.

Advantages



Waterproof



UV Resistant



100% Termite-Free



Easy Maintenance



No Hazardous
Chemicals



Environmentally
Friendly

EXTERIOR DOOR



Entrance



Pivot



Fiberglass



CONFIGURATIONS



DOUBLE SWING

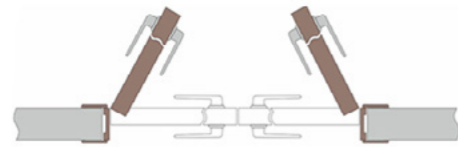

This is the most common and popular entryway configuration, consisting of two door slabs, matching jambs and casings, extensions (if necessary), hinges, a lock, and a handle (single- or double-sided). Double magnetic catches are used in closet openings to keep the shutters closed. In inter-room doorways, one slab is usually fixed with a flush bolt, while the other is the active slab. An astragal is used to seal a small gap between the two shutters, a vertical molding attached to one or both swinging doors against which the other door seals when closed.



DOUBLE POCKET



A bi-fold door is a type of door that opens by sliding the panels and folding them up. It optimizes floor space since it requires half the amount of room needed by swinging ones. Additionally, it provides an opportunity to create an unusual interior design. Bi-fold door units are commonly used in closets.



BIFOLD SYSTEM



A bi-fold door is a type of door that opens by sliding the panels and folding them up. It optimizes floor space since it requires half the amount of room needed by swinging ones. Additionally, it provides an opportunity to create an unusual interior design. Bi-fold door units are commonly used in closets.

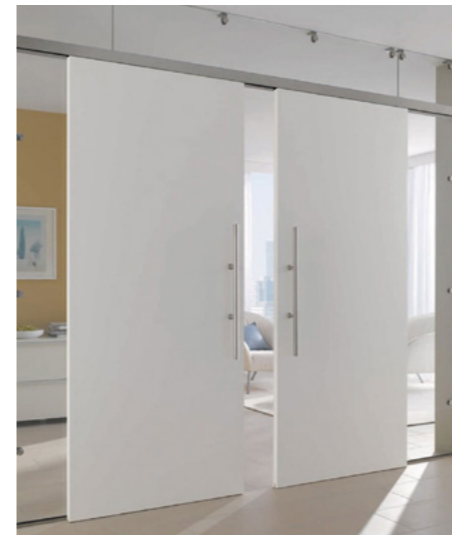

BYPASS SYSTEM

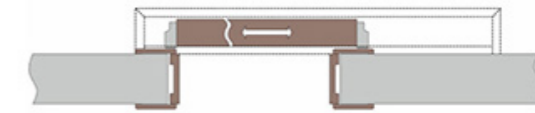

A bypass door is a sliding one that opens horizontally by having one door slide in front of the other parallel to a wall. It's a popular choice for closet openings and can be used instead of bi-fold systems. Our bypass entry units have high-quality tracks and modern flush pulls.



BARN SYSTEM

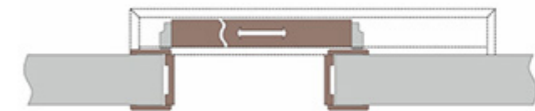

The Barn System is a contemporary alternative to traditional swinging doors. It allows for an entrance to slide along a wall on exceptional guides, utilizing roller systems and a rail mechanism with a stopper intended for hinged single-door panels situated in the design's top part. This system does not use a threshold, allowing for a whole door opening that gives the impression of complete space. It is practical and convenient for disabled individuals or for cleaning the room.



INVISIBLE SYSTEM

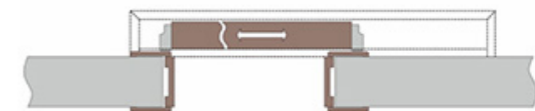

The Barn System is a contemporary alternative to traditional swinging doors. It allows for an entrance to slide along a wall on exceptional guides, utilizing roller systems and a rail mechanism with a stopper intended for hinged single-door panels situated in the design's top part. This system does not use a threshold, allowing for a whole door opening that gives the impression of complete space. It is practical and convenient for disabled individuals or for cleaning the room.

ACCESSORIES

The top quality door request the same level hardware accessories. No matter stainless steel 304 or 201 hinges, knob lock, handle lock, seperated lock, even fire rated UL certificated lock. Including door stopper, closer, peephole, you can get them all here.



LOCK201B



LOCK505



LOCK508HAFELE



LOCK201HAFELE



LOCK101



LOCK507HAFELE



LOCK207



LOCK207B



HINGE206B



HINGE206



HINGE201



HINGE101



LOCK614



HANDLE221



TP221



CLOSER101

DOOR FRAME

Door jambs and architrave will decorate door leaf to a finished set of door. Simple door jambs, and adjustable door frame are the most popular frame. Except that, 100% waterproof WPC frame is more and more popular recent years.

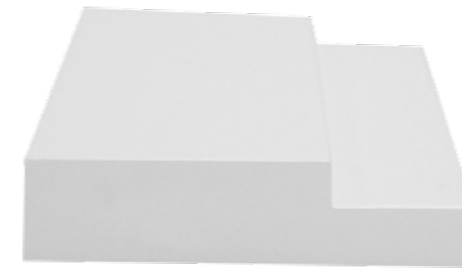

Simple Door Frame



White Adjustable Door Frame



Wood Veneer Door Frame



Fire Rated Door Frame

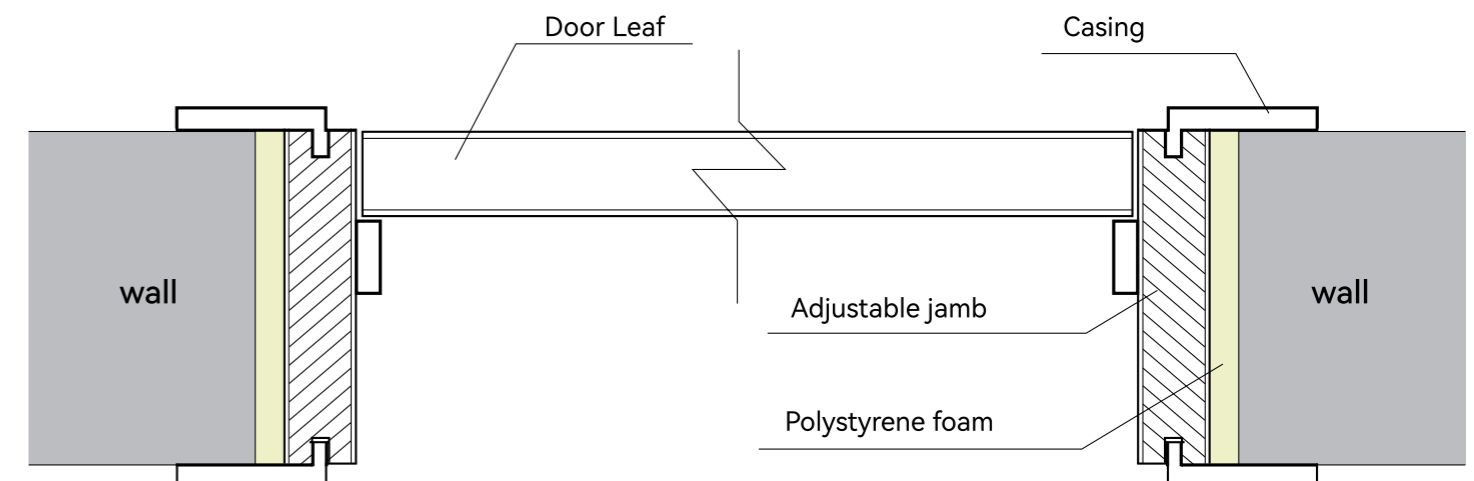

Customized Design Service

Kangton supply customized design service that can match the brands of top level developers and provide professional solutions for building renovation, interior design, soft furnishing design.

Interior Design FF&E Design



Professional honor awards

Kangton design team have been recognized for our originality and creativity with over 100+ national and international awards

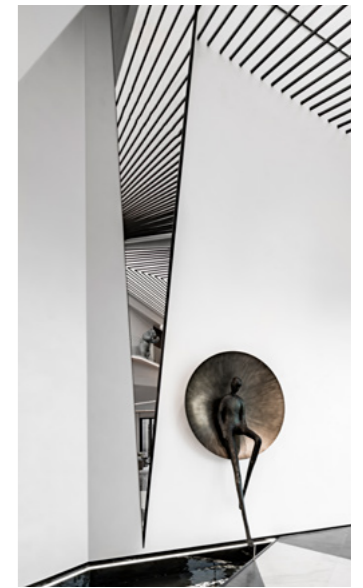
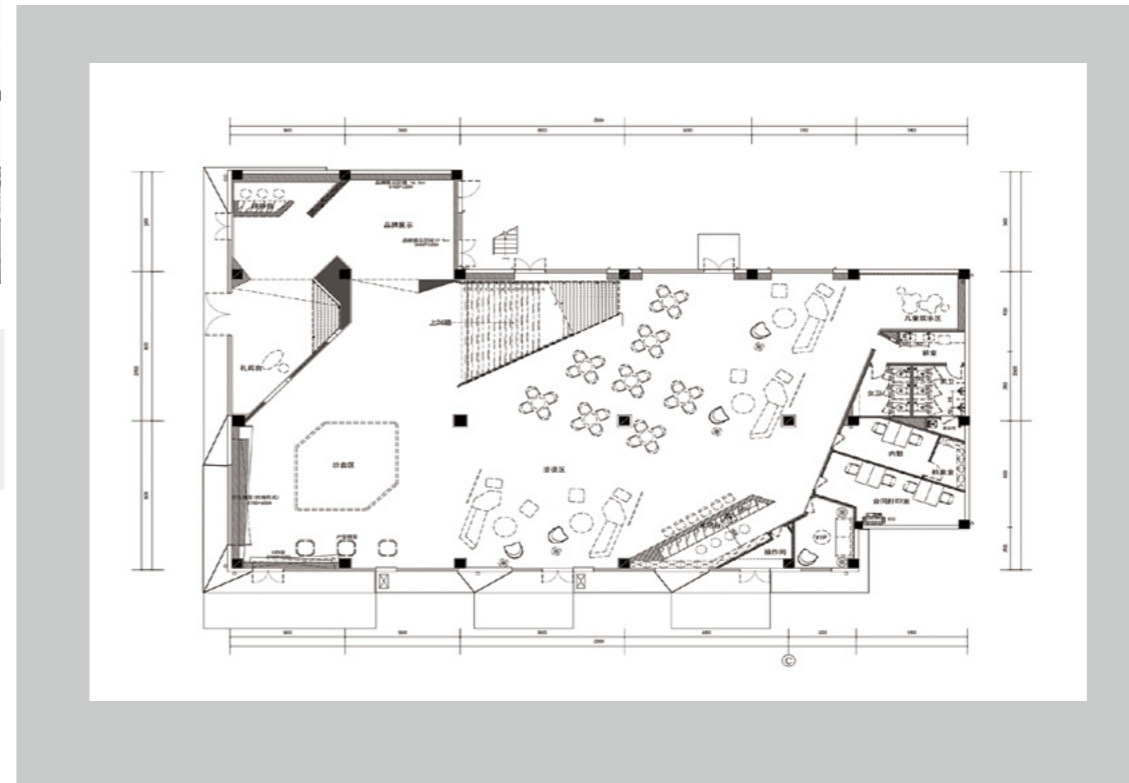

PROJECT SHOW

From 5 star hotel, luxury resort vila, commercial office to residential house, government project, Kangton doors are all over the world. The most durable and top level performance make your project successfully and perfect.

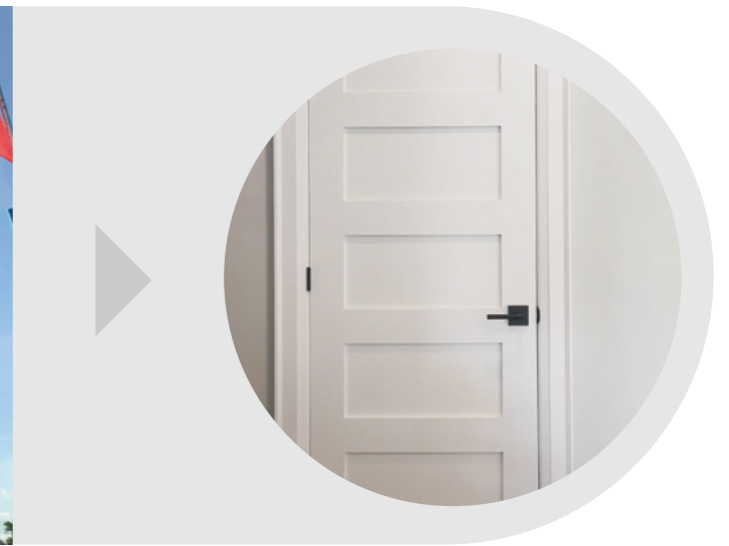
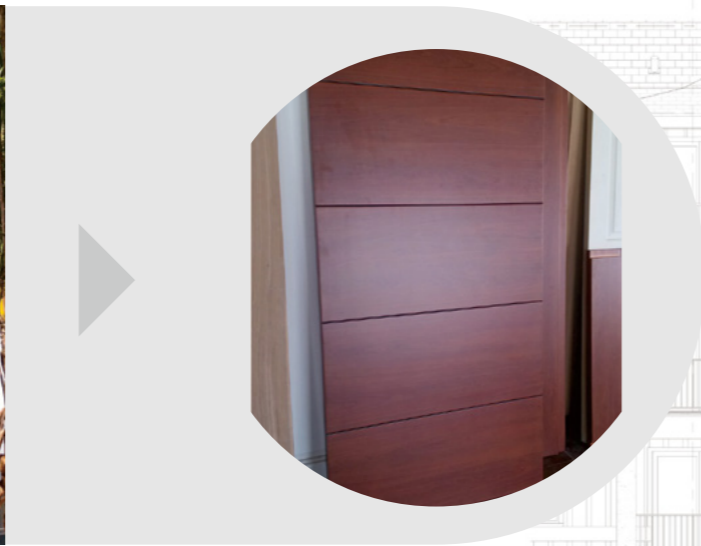

BUSINESS PARTNER



New York | London | Dubai | Melbourn

Manila | Los Angeles | Toronto | Paris